

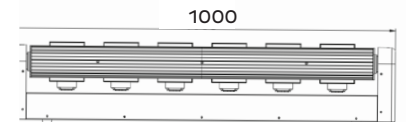

RAZOR RGB61000 is a moving head diode rotating laser bar equipped with 6 RGB beam laser outlets of 1000mW diodes each. This multi effect laser bar creates fans of large laser beams with broad projection of bright RGB color mixing. It is the ideal effect for stages, live gigs and nightclubs, as well as for TV Shows and show productions.

LASER Source: 6 x 1000 mW diodes
 Power: 6 watts
 Red power/wavelength: 260mW 638nm
 Green power/wavelength: 340mW 515nm
 Blue power/wavelength: 400mW 450nm
 Color mixing: RGB
 Beam size: 3.5cm at 3m distance
 Laser safety: Class 3B
 Life expectancy: 2000 Hrs.

Dimensions



DYNAMIC EFFECTS Color mixing: RGB
 Individual diode output control
 Individual diode pan
 Electronic strobe: 0-23 Hz
 Built-in dynamic macros

CONTROL & PROGRAMMING Control protocols: DMX, Auto, Sound, Master-slave
 Display: LED display with 4 control buttons
 DMX channels: 9, 19-1, 19-2, 32 CHs

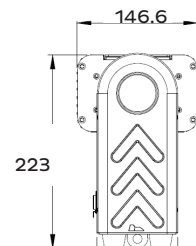

MOVEMENT Pan: 240°
 Tilt: 90°

ELECTRICAL Input voltage: AC100-240V 50/60Hz
 Power consumption: 120 watts

CONNECTIONS DMX connections: 3 pin XLR In/Out male and female
 Power connections: PowerCon In/Out

PHYSICAL Dimensions: 1000 x 146.6 x 223mm
 Net weight: 14.2 Kg
 Color: Black
 IP rating: 20
 Operating temperature: 10°C/40°C